

BMS 45 - ASME B16.47 B Camprofile Gaskets
(Formerly API 605)
Dimensions & Tolerances (All Classes)

Issued by: A D Senior
Date: 1st Jan 2011
Page: 1 of 5

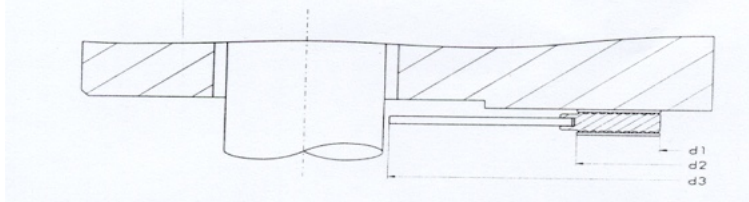

Class 150 LB

NOM BORE INCHES	CENTERING RING		SEALING ELEMENT	
	OD	OD	ID	
	mm	mm	mm	
	d3	d2	d1	
26	725.4	698.5	673.1	
28	776.2	749.3	723.9	
30	827.0	800.1	774.7	
32	881.1	850.9	825.5	
34	935.0	908.1	876.3	
36	987.6	958.9	927.1	
38	1044.7	1009.7	974.9	
40	1095.5	1063.8	1022.4	
42	1146.3	1114.6	1079.5	
44	1197.1	1165.4	1124.0	
46	1255.8	1224.0	1181.1	
48	1306.6	1270.0	1231.9	
50	1357.4	1325.6	1282.7	
52	1408.2	1376.4	1333.5	
54	1463.8	1422.4	1384.3	
56	1514.6	1478.0	1444.8	
58	1579.6	1528.8	1500.1	
60	1630.4	1586.0	1557.3	

Tolerances:

DN (mm)	DN (mm)	d1	d2	d3
15 to 200	1/2 to 8	+ / - 0.4	+ / - 0.8	+ / - 0.8
250 to 600	10 to 24	+ / - 0.8	+ 1.5 / - 0.8	+ / - 0.8
650 to 850	26 to 34	+ / - 0.8	+ / - 1.5	+ / - 0.8
900 to 1500	36 to 60	+ / - 1.25	+ / - 1.5	+ / - 0.8

UN

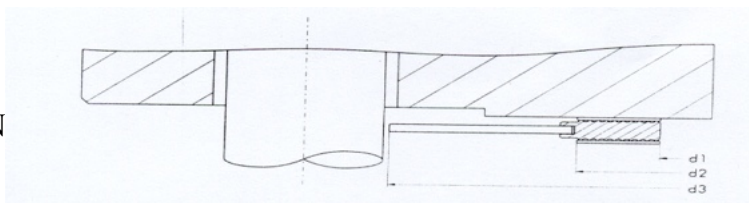

use

BMS 45 - ASME B16.47 B Camprofile Gaskets
(Formerly API 605)
Dimensions & Tolerances (All Classes)

Issued by:	A D Senior
Date:	1st Jan 2011
Page:	2 of 5

Class 300 LB

NOM BORE INCHES	CENTERING RING		SEALING ELEMENT	
	OD	OD	ID	
	mm	mm	mm	
	d3	d2	d1	
26	771.7	711.2	673.1	
28	825.5	762.0	723.9	
30	886.0	812.8	774.7	
32	939.8	863.6	825.5	
34	993.9	914.4	876.3	
36	1047.8	965.2	927.1	
38	1098.6	1047.8	1009.7	
40	1149.4	1098.6	1060.5	
42	1200.2	1149.4	1111.3	
44	1251.0	1200.2	1162.1	
46	1317.8	1254.3	1216.2	
48	1368.6	1311.4	1263.7	
50	1419.4	1355.9	1317.8	
52	1470.2	1406.7	1368.6	
54	1530.4	1454.2	1403.4	
56	1593.9	1524.0	1479.6	
58	1655.8	1573.3	1535.2	
60	1706.6	1630.4	1589.0	

Tolerances:

DN (mm)	DN (mm)	d1	d2	d3
15 to 200	1/2 to 8	+ / - 0.4	+ / - 0.8	+ / - 0.8
250 to 600	10 to 24	+ / - 0.8	+ 1.5 / - 0.8	+ / - 0.8
650 to 850	26 to 34	+ / - 0.8	+ / - 1.5	+ / - 0.8
900 to 1500	36 to 60	+ / - 1.25	+ / - 1.5	+ / - 0.8

UNCC

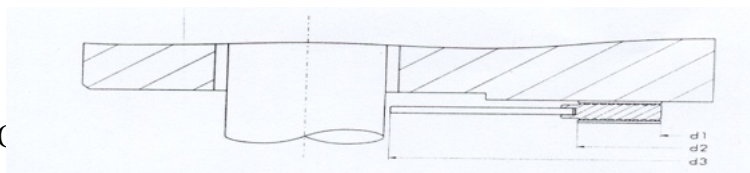

.se

BMS 45 - ASME B16.47 B Camprofile Gaskets
 (Formerly API 605)
 Dimensions & Tolerances (All Classes)

 Issued by: A D Senior
 Date: 1st Jan 2011
 Page: 3 of 5

Class 400 LB

NOM BORE INCHES	CENTERING RING		SEALING ELEMENT	
	OD	OD	ID	
	mm	mm	mm	
	d3	d2	d1	
26	746.3	698.5	666.8	
28	800.1	749.3	714.5	
30	857.3	806.5	765.3	
32	911.4	860.6	812.8	
34	962.2	911.4	866.9	
36	1022.4	965.2	917.7	
38	1073.2	1022.4	971.6	
40	1127.3	1076.5	1025.7	
42	1178.1	1127.3	1076.5	
44	1231.9	1181.1	1130.3	
46	1289.1	1244.6	1193.8	
48	1346.2	1295.4	1244.6	
50	1403.4	1346.2	1295.4	
52	1454.2	1397.0	1346.2	
54	1517.7	1454.2	1403.4	
56	1568.5	1505.0	1454.2	
58	1619.3	1555.8	1505.0	
60	1682.8	1619.3	1568.5	

Tolerances:

DN (mm)	DN (mm)	d1	d2	d3
15 to 200	1/2 to 8	+ / - 0.4	+ / - 0.8	+ / - 0.8
250 to 600	10 to 24	+ / - 0.8	+ 1.5 / - 0.8	+ / - 0.8
650 to 850	26 to 34	+ / - 0.8	+ / - 1.5	+ / - 0.8
900 to 1500	36 to 60	+ / - 1.25	+ / - 1.5	+ / - 0.8

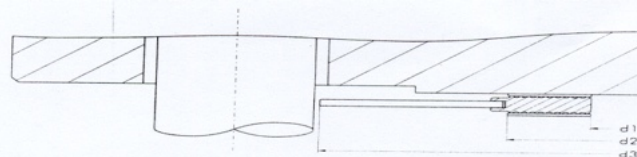

UNCONTROLLED IF PRINTED – Verify date of issue before use

BMS 45 - ASME B16.47 B Camprofile Gaskets
 (Formerly API 605)
 Dimensions & Tolerances (All Classes)

 Issued by: A D Senior
 Date: 1st Jan 2011
 Page: 4 of 5

Class 600 LB

NOM BORE INCHES	CENTERING RING		SEALING ELEMENT	
	OD	OD	ID	
	mm	mm	mm	
	d3	d2	d1	
26	765.3	714.5	663.7	
28	819.2	755.7	704.9	
30	879.6	828.8	778.0	
32	933.5	882.7	831.9	
34	997.0	939.8	889.0	
36	1047.8	990.6	939.8	
38	1104.9	1041.4	990.6	
40	1155.7	1098.6	1047.8	
42	1219.2	1155.7	1104.9	
44	1270.0	1212.9	1162.1	
46	1327.2	1263.7	1212.9	
48	1390.7	1320.8	1270.0	
50	1447.8	1371.6	1320.8	
52	1498.6	1422.4	1371.6	
54	1555.8	1479.6	1428.8	
56	1612.9	1530.4	1479.6	
58	1663.7	1587.5	1536.7	
60	1733.6	1644.7	1593.9	

Tolerances:

DN (mm)	DN (mm)	d1	d2	d3
15 to 200	1/2 to 8	+ / - 0.4	+ / - 0.8	+ / - 0.8
250 to 600	10 to 24	+ / - 0.8	+ 1.5 / - 0.8	+ / - 0.8
650 to 850	26 to 34	+ / - 0.8	+ / - 1.5	+ / - 0.8
900 to 1500	36 to 60	+ / - 1.25	+ / - 1.5	+ / - 0.8

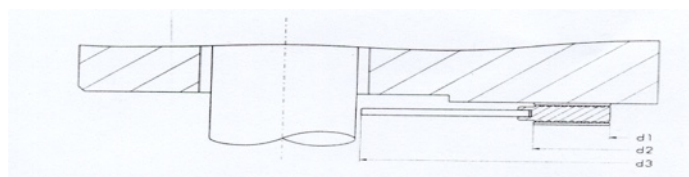

BMS 45 - ASME B16.47 B Camprofile Gaskets
 (Formerly API 605)
 Dimensions & Tolerances (All Classes)

Issued by:	A D Senior
Date:	1st Jan 2011
Page:	5 of 5

Class 900 LB

NOM BORE INCHES	CENTERING RING	SEALING ELEMENT	
	OD	OD	ID
	mm	mm	mm
	d3	d2	d1
26	838.2	749.3	692.2
28	901.7	800.1	743.0
30	958.9	857.3	806.5
32	1016.0	914.4	863.6
34	1073.2	971.6	920.8
36	1124.0	997.0	946.2
38	1200.2	1085.9	1035.1
40	1251.0	1149.4	1098.6
42	1301.8	1200.2	1149.4
44	1368.6	1257.3	1206.5
46	1435.1	1320.8	1270.0
48	1485.9	1371.6	1320.8

Tolerances:

DN (mm)	DN (mm)	d1	d2	d3
15 to 200	1/2 to 8	+ / - 0.4	+ / - 0.8	+ / - 0.8
250 to 600	10 to 24	+ / - 0.8	+ 1.5 / - 0.8	+ / - 0.8
650 to 850	26 to 34	+ / - 0.8	+ / - 1.5	+ / - 0.8
900 to 1500	36 to 60	+ / - 1.25	+ / - 1.5	+ / - 0.8